

● **Descrizione / Description**

LED driver corrente costante, con uscita multipla 350~1050mA - 40W, selezionabile mediante dip-switch. Classe II, morsetti a vite.

DRM1050040.220: Dimmerabile DALI e funzione "push dimming".

DRM1050040.221: Dimmerabile 0~10V e PWM.

Con funzione master/slave (max 10 unità).

Constant current LED driver, multiple output: 350~1050mA - 40W, selectable by DIP-switch. Class II, screw terminals.

DRM1050040.220: Dimmable DALI and push-dimming.

DRM1050040.221: Dimming 0~10V and PWM.

With master/slave function (max 10 units).

● **Temperatura / Temperature**

t_c : + 90°C / t_a : + 60°C

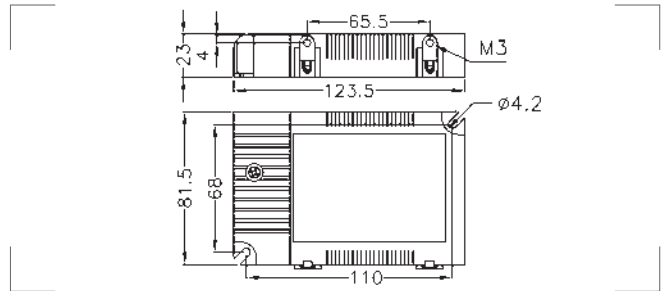

Codice Code	Tensione di ingresso Input voltage (Vac)	Uscita Output (Cc)	Uscita Output (Vdc)	Load Range (W)	Uscita Output (Cc)	Uscita Output (Vdc)	Load Range (W)
DRM1050040.220 / DRM1050040.221	180~295V (47/63Hz)	350mA	2~100V	35W	700mA	2~57V	40W
		500mA	2~80V	40W	900mA	2~45V	40W
		600mA	2~67V	40W	1050mA	2~40V	42W